

SOLOLIFT2 WC-1, WC-3 & CWC-3

GRUNDFOS 
HiFLO PUMPS
Service . Expertise . Quality

COMPACT GREY WATER AND BLACKWATER HANDLING STATION

WATER SOURCE



Blackwater



Grey Water

APPLICATION



Blackwater
Handling



Grey Water
Handling



SCAN THE QR CODE
TO LINK TO GRUNDFOS
PRODUCT CENTER

The Grundfos SOLOLIFT2 WC-1, WC-3 and CWC-3 lifting stations are all-in-one grinding and pumping units designed for the effective handling of a combination of bathroom grey water and toilet wastewater. Designed to be installed below street level or away from existing sewerage pipework.

- **Very low maintenance** - Thanks to the powerful built-in grinder, blockages are greatly minimised
- **Space saving design fits small spaces** - Compact units making them suitable for installation in to small bathrooms
- **Low installation costs** - Plumbing connections are adjustable up to 10 mm, making installation to existing or new pipework simple and inexpensive

SOLOLIFT2 WC-1 - Suitable for connection to one floor mounted toilet and one additional appliance, such as a handbasin.

SOLOLIFT2 WC-3 - Suitable for connection to one floor mounted toilet and a maximum of three additional appliances, such as hand basins or a shower.

SOLOLIFT2 CWC-3 - Compact unit suitable for connection to one wall mounted toilet and a maximum of three additional appliances, such as hand basins or shower.



SOLOLIFT2 WC-1

SOLOLIFT2 WC-3

SOLOLIFT2 CWC-3

PUMP SIZING

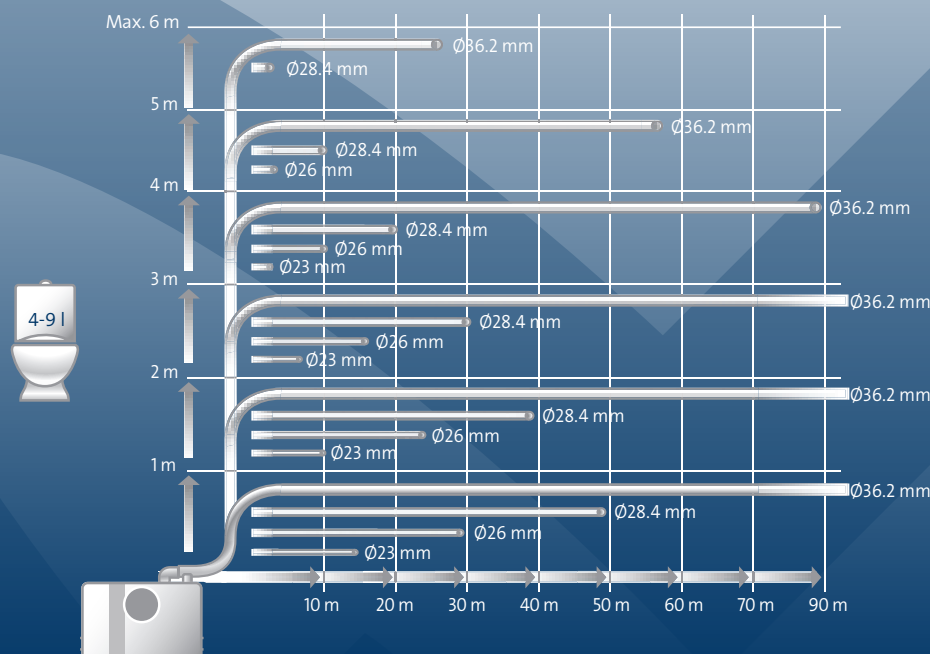

TECHNICAL DATA

INSTALLATION SCHEMATIC*

SOLOLIFT2 WC-1

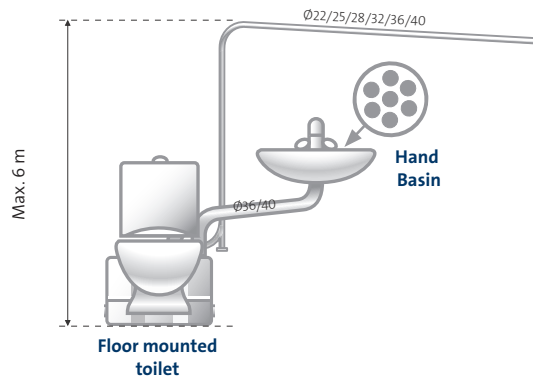

SOLOLIFT2 WC-3

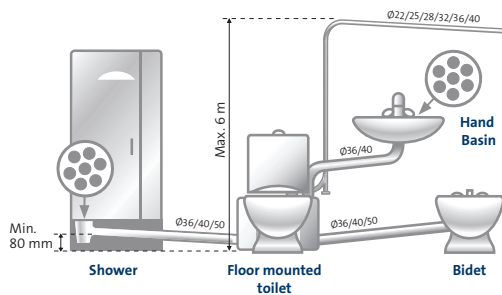

SOLOLIFT2 CWC-3

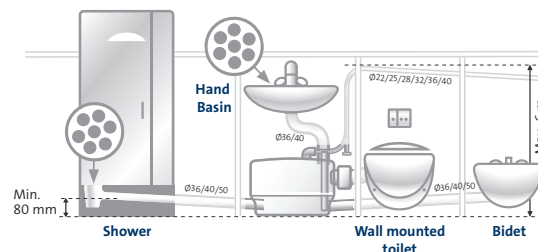

*Illustrative purposes only

OPERATING CONDITIONS

Liquid Temperature	0°C to +50°C
pH value of pumped liquid	4-10
Tank Volume	9.0 litres
Sound Pressure	Max. 70 dB

TECHNICAL DATA

Power Supply Voltage	220-240 Volt, 50 Hz
Power Supply Cable	5 m with plug
Enclosure Class	Requires indoor installation (IP44)
Approvals and Markings	WaterMark Approved C-Tick Compliance

PHYSICAL ATTRIBUTES

SOLOLIFT2 WC-1 & WC-3

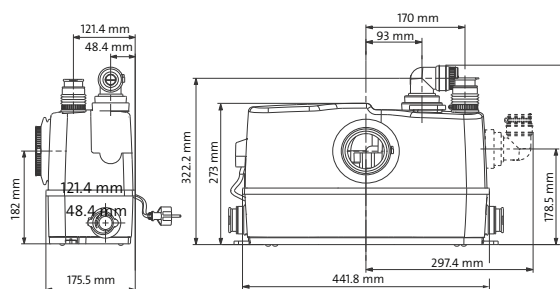

SOLOLIFT2 CWC-3

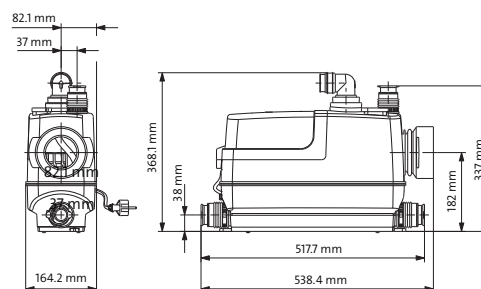

Model	Motor Power P2 (kW)	Connections						Weight (kg)
		Inlet (Toilet)	Inlet (Top)	Inlet (Right)	Inlet (Left)	Outlet (Top)	Outlet (Side)	
SOLOLIFT2 WC-1	0.42	100 mm	32/36/40 mm	-	-	22-40 mm	22-40 mm	7
SOLOLIFT2 WC-3	0.42	100 mm	32/36/40 mm	36/40/50 mm	36/40/50 mm	22-40 mm	22-40 mm	7
SOLOLIFT2 CWC-3	0.42	100 mm	6/40 mm	50 mm	-	22-40 mm	-	7

Visit our Auckland or Rotorua Branch to have a chat about the Sololift WC. Alternatively flick us a call or email, and we will get back to you ASAP.

Hi Flo Auckland Branch
3 Fairfax Avenue, Penrose, Auckland 1642
09 579 6375
Sales@hiflopumps.co.nz

Hi Flo Rotorua Branch
72 Old Taupo Road, Mangakakahi, Rotorua 3015
07 348 7516
Sales@hiflopumps.co.nz